

## Pôdorys 1.NP

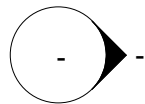

Zastavaná plocha 68,06 m<sup>2</sup>  
 Úžitková plocha 51,68 m<sup>2</sup>  
 Obytná plocha 30,56m<sup>2</sup>

## Pôdorys 2.NP

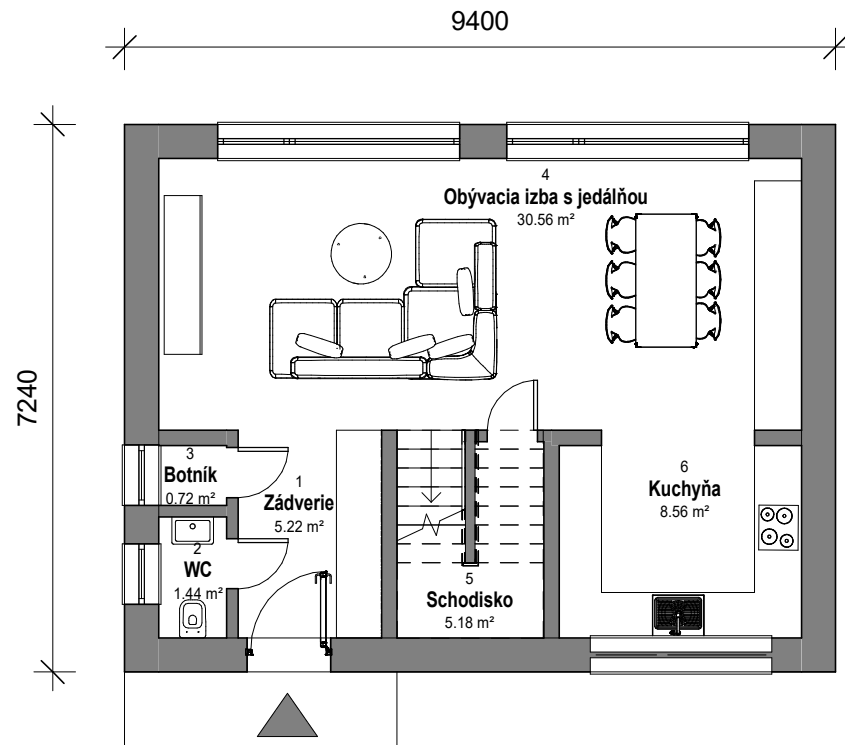
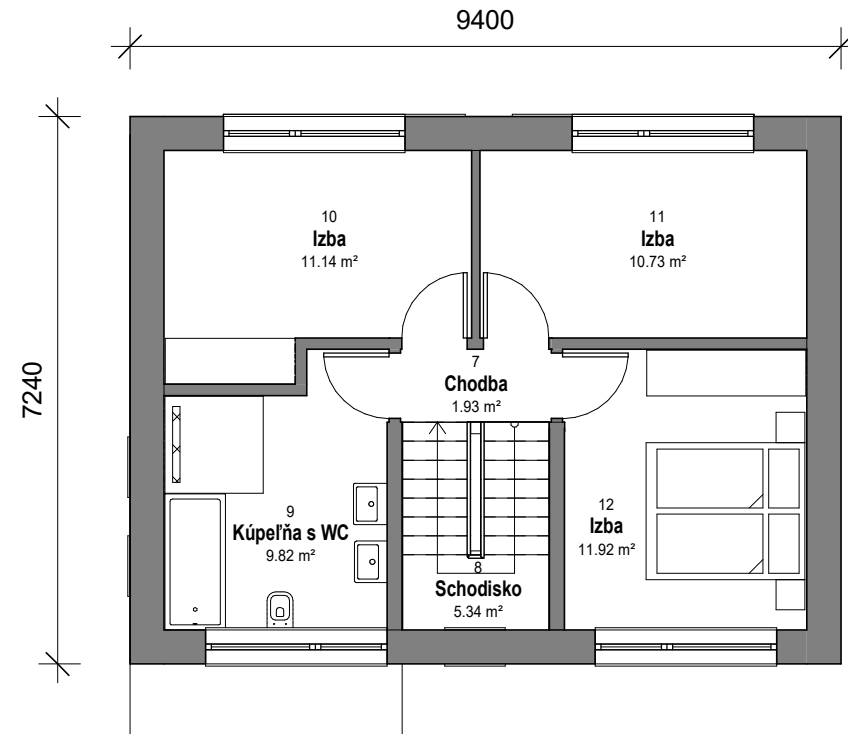

Zastavaná plocha 68,06 m<sup>2</sup>  
 Úžitková plocha 50,88 m<sup>2</sup>  
 Obytná plocha 33,79 m<sup>2</sup>