

## Pôdorys 1.NP

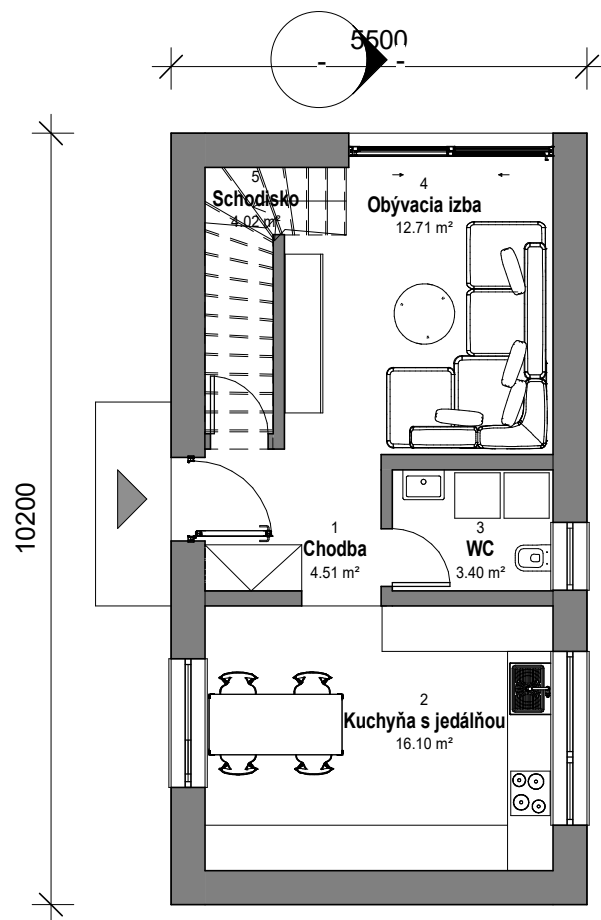

Zastavaná plocha 56,10 m<sup>2</sup>

Úžitková plocha 40,74 m<sup>2</sup>

Obytná plocha 28,71 m<sup>2</sup>

## Pôdorys 2.NP

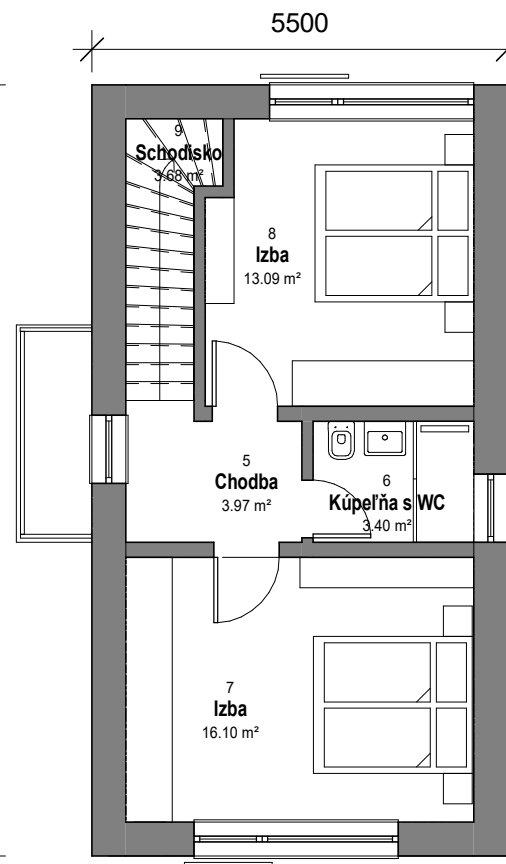

Zastavaná plocha 56,10 m<sup>2</sup>

Úžitková plocha 40,78 m<sup>2</sup>

Obytná plocha 29,19 m<sup>2</sup>